

GEDORE

TOOLS FOR LIFE

Pressing Device with Hydr. Cyl., Rear Silentbloc, Ford, Volvo

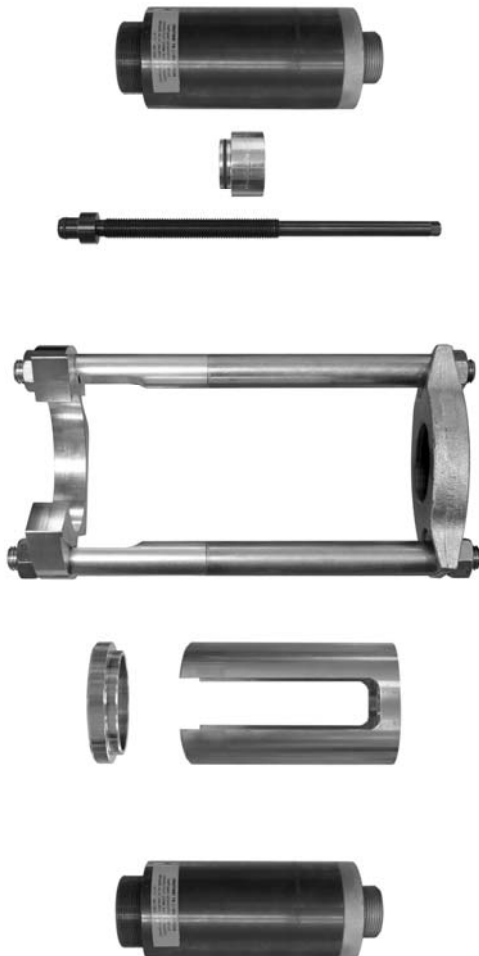

KL-0610-15 A



0610-15Ae150710_g.docx

GEDORE Automotive GmbH

Breslauer Straße 41
78166 Donaueschingen

Postfach 1329
78154 Donaueschingen - GERMANY

Phone: +49 (0) 771 / 8 32 23-0
Fax: +49 (0) 771 / 8 32 23-90

Email: info@gedore-automotive.com
Internet: www.gedore-automotive.com

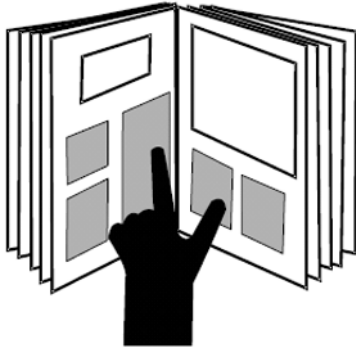
**Impressum**

Im Zuge der Verbesserung und Anpassung an den Stand der Technik behalten wir uns Änderungen im Hinblick auf Aussehen, Abmessungen, Gewichte und Eigenschaften sowie Leistungen vor. Damit ist kein Anspruch auf Korrektur oder Nachlieferung bereits gelieferter Produkte verbunden. Streichungen können jederzeit vorgenommen werden, ohne dass ein rechtlicher Anspruch entsteht.

Alle Hinweise zur Benutzung und Sicherheit sind unverbindlich. Sie ersetzen keinesfalls irgendwelche gesetzlichen oder berufsgenossenschaftlichen Vorschriften.

Für Druckfehler übernehmen wir keine Haftung.

Ein Nachdruck, auch auszugsweise, bedarf der vorherigen schriftlichen Zustimmung durch KLANN-Spezial-Werkzeugbau GmbH.

Alle Rechte weltweit vorbehalten.

Wir verweisen auf unsere Allgemeinen Geschäftsbedingungen, ersichtlich im Impressum unter www.klann-online.de.

© Copyright by KLANN-Spezial-Werkzeugbau GmbH Donaueschingen

Legal Notice

Due to continuous improvements and adaptation to state-of-the-art technology, we reserve the right to make modifications to our products with regard to design, dimension, weight, features and performances at any time and without prior notice.

Thus, the right to adjustments or replacement deliveries of goods already delivered is excluded. Cuts and cancellations can be made by us at any time without the right to legal claim.

All indications regarding use and safety are given for information only and without any commitment. In no case do they substitute for legal provisions or the regulations of the Employer's Liability Insurance Association.

Errors and omissions excepted.

All information and technical data in this document were compiled with the utmost care. However, KLANN assumes no responsibility for possible errors and omissions.

Any reproduction, also in extracts, is subject to the prior and written consent of KLANN Spezial-Werkzeugbau-GmbH.

All rights reserved.

We refer to our General Terms and Conditions of Sale under 'Legal Notice' at www.klann-online.de.

© Copyright by KLANN Spezial-Werkzeugbau-GmbH Donaueschingen

Impressum/Mentions légales

En raison des améliorations continues que nous apportons à nos produits et pour assurer leur adaptation constante à l'évolution des techniques, nous nous réservons le droit de procéder à des modifications de nos produits quant à l'apparence, aux dimensions, aux poids, aux caractéristiques et aux performances à tout moment sans préavis et sans obligation de modifier ou de remplacer des produits précédemment livrés. Des suppressions peuvent être effectuées à tout moment et sans préavis sans qu'elles puissent donner lieu à réclamation.

Toutes les instructions d'utilisation et conseils de sécurité sont donnés sans engagement de notre part. Ils ne se substituent en aucun cas aux réglementations légales en vigueur ou à celles émises par les associations professionnelles.

Le plus grand soin possible a été apporté à la rédaction de ce document. Toutefois, nous n'assumons aucune responsabilité pour des erreurs, omissions ou défauts d'impression éventuels.

Une reproduction, même en partie, ne peut être effectuée qu'après autorisation écrite préalable de KLANN Spezial-Werkzeugbau GmbH.

Tous droits réservés.

Vous trouverez nos conditions générales de vente, sous Impressum/Mentions légales sur www.klann-online.de.

© Copyright by KLANN-Spezial-Werkzeugbau GmbH Donaueschingen

Table of Contents

	Page
1. Essential Safety Notices	10
1.1 Safety Notices and Warnings	10
1.2 Personal Protective Equipment	10
1.3 Intended Use	11
1.4 Safe and Proper Use	11
1.5 Work Environment.....	11
1.6 Appropriate Users	11
2. Product Description.....	12
2.1 KL-0610-15 A - Pressing Device with Hydraulic Cylinder, Rear Silentbloc, Ford/Volvo.....	12
2.2 Technical Data	12
3. Preparatory Work.....	12
3.1 Checking the Delivery.	12
3.2 Preparing the Vehicle.....	12
3.3 Preparing the Tool.....	12
4. Silentbloc Removal / Silentbloc Installation	13
4.1 Removing the Silentbloc	13
4.2 Installing the Silentbloc	13
5. Care and Storage	14
6. Accessories.....	14
7. Maintenance and Repair by the GEDORE Automotive Service Centre	14
8. Spare Parts List.....	14
9. Environmentally Safe Disposal.....	14



1. Essential Safety Notices

⚠ Before using the pressing device, it is imperative that you read and understand the instruction manual. Misuse can lead to **SERIOUS INJURIES** and even **DEATH**.

This instruction manual is part of the pressing device. Keep the instruction manual in a safe place for future reference and pass it on to subsequent users of the pressing device.

1.1 Safety Notices and Warnings

For better differentiation, the warning notices in this instruction manual are classified as follows:

Warning sign	Sign reads	Meaning
	DANGER	Indicates a hazardous situation which, if not avoided, may result in serious or fatal injuries .
	CAUTION	Indicates a hazardous situation which, if not avoided, may result in moderate or minor injuries .
	ATTENTION	Indicates a situation which, if not avoided, may result in possible damage to the pressing device or its functioning, or to objects in its vicinity.

⚠ DANGER

When removing and installing silentblocs, there is a risk that the press frame could break and fall to pieces. This will lead to parts becoming projectiles.

- Observe and do not exceed the maximum load capacity.
- Use hydraulic pump with pressure gauge **KL-0040-2529**.
- Only use GENUINE GEDORE Automotive spare parts.
- Always keep all parts of your body away from the axial extension of the press frame.

⚠ CAUTION

A falling tool can cause injuries.

- Always wear safety shoes/boots.

ATTENTION

- Lubricate spindles with molybdenum disulphide paste **KL-0014-0030** (accessory).

1.2 Personal Protective Equipment

ALWAYS wear personal protective equipment when using the pressing device. The pressing device can cause mechanical hazards leading to injuries such as contusions, cuts or concussions.



EYE PROTECTION (see OSHA 29 CFR 1910.133 and ANSI Z87) designed to protect you from flying debris/objects must be worn when using the pressing device.

- Particles may be ejected at very high speed while working with the pressing device and could cause serious injuries to your eyes.



SAFETY GLOVES must be worn when using the pressing device.

- Working with the pressing device can cause skin abrasions and contusions.



SAFETY SHOES/BOOTS with slip resistant soles and steel-toe caps (see OSHA 29 CFR 1910.136 and ANSI 241) must be worn when using the pressing device.

- Falling parts can cause injuries to feet and toes.

1.3 Intended Use

-  The pressing device is only designed for the removal and installation of the silentblocs that are found at the rear axle trailing arm on: Ford Galaxy (from 05/2006 onwards), Mondeo (from 2007 onwards), S-Max (from 2006 onwards) and Volvo S60/V60 (134/155), XC 60 (156), S80 (124/144), V70 / XC70 (135/136).

The pressing device may only be used in the manner as described in this instruction manual.

- Any other use can result in severe injuries or even death.

1.4 Safe and Proper Use

Take the following safety precautions to prevent injuries and damage that could be caused by improper handling or unsafe use of the pressing device.

-  Misuse can result in extremely severe injuries or even death.
- NEVER overload the pressing device.
 - ALWAYS check the pressing device prior to EACH use in order to ensure that it is in good order and condition.
 - ALWAYS replace any damaged or worn parts prior to using the tool.
 - ONLY use the Original spare parts and accessories from GEDORE Automotive on the pressing device.

1.5 Work Environment

Work with the pressing device should only be carried out in a safe work environment.

- The workplace should always be clean and tidy.
- The workplace should be sufficiently large and secured.

1.6 Appropriate Users

This instruction manual is designed for technicians in workshops.

DO NOT allow children to use the pressing device.

Purchasers/employers purchasing the pressing device MUST ensure that any person/employee using the pressing device have read and understood this instruction manual prior to using the tool. This instruction manual MUST be made available to the users of the pressing device for reference at all times.

Fig. 1: KL-0610-15 A

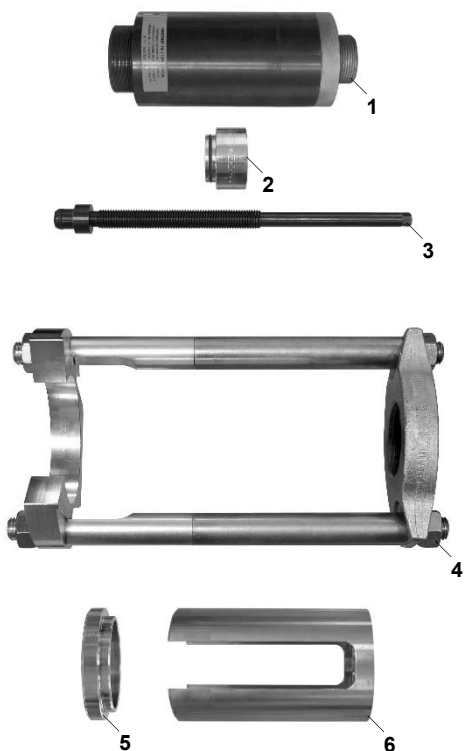

2. Product Description

2.1 KL-0610-15 A - Pressing Device with Hydr. Cyl., Rear Silentbloc, Ford/Volvo

Suitable for the silentblocs that are found at the rear axle trailing arm on: Ford Galaxy (from 05/2006 onwards), Mondeo (from 2007 onwards), S-Max (from 2006 onwards) and Volvo S60/V60 (134/155), XC 60 (156), S80 (124/144), V70 / XC70 (135/136).

Designed for the quick, safe and professional removal and replacement of the silentblocs that are found on rear axle trailing arms.

Removal and installation of the silentblocs can be carried out in situ on the vehicle within just a few minutes, without having to dismount the rear axle trailing arm.

The special design and shape of the support ring and pressure sleeve ensure that even seized or heavily corroded silentblocs can be pressed out properly and without any trouble. The tool also facilitates the accurate positioning of the new silentbloc thus ensuring its correct installation.

Note:

The **KL-0215-35 M25** hydraulic hand pump (accessory) is needed to drive the hydraulic cylinder **KL-0040-2500**.

The hydraulic pressure and necessary force can be checked while operating the pump at pressure gauge **KL-0040-2529** (supplied with the tool set). The pressure gauge features a tonne scale specifically adapted to our **KL-0040-2500** hydraulic cylinder (17 t).

Pos.	Part No.	Description
1	KL-0040-2500	Hydraulic Cylinder 17 t
2	KL-0039-1002	Retaining Adaptor with O-Ring, for Clamping Nut M20
3	KL-0039-1930	Pressure Spindle with O-Ring, M20 x 350 mm
4	KL-0610-1501	Frame
5	KL-0610-1503	Adaptor
6	KL-0610-1502	Pressure Sleeve, Ford/Volvo

2.2 Technical Data

Max. load capacity of hydraulic cylinder	17 t
Max. load capacity of press frame	12 t
Pressure sleeve inner diameter	Ø 70 mm
Inner length (press frame)	245.5 mm
Outer length (press frame)	332 mm

3. Preparatory Work

Before the first commissioning of the pressing device, check and confirm you have all the parts listed in the scope of delivery. Then, read and follow the mounting instructions.

3.1 Checking the Delivery.

KL-0610-15 A - Pressing Device (Fig.1)

3.2 Preparing the Vehicle.

Loosen and/or remove components/parts as may be necessary.

3.3 Preparing the Tool.

Prepare the pressing device as shown in Fig. 2.

Note: Observe correct installation position of support ring "7". (see Fig. 2)

Fig. 2: Preparing the pressing device.

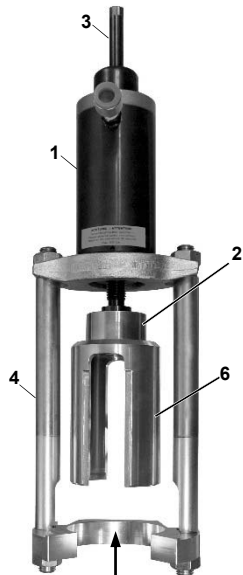

Note on assembling/mounting the frame:

The flat side of the support ring "7" must be facing downwards,
the grooved side must be facing upwards.

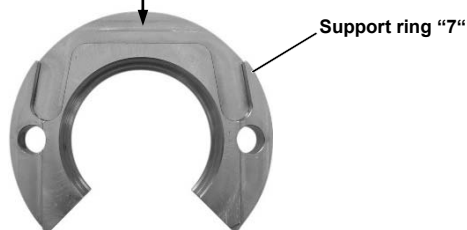

Fig. 3: Removing the silentbloc.

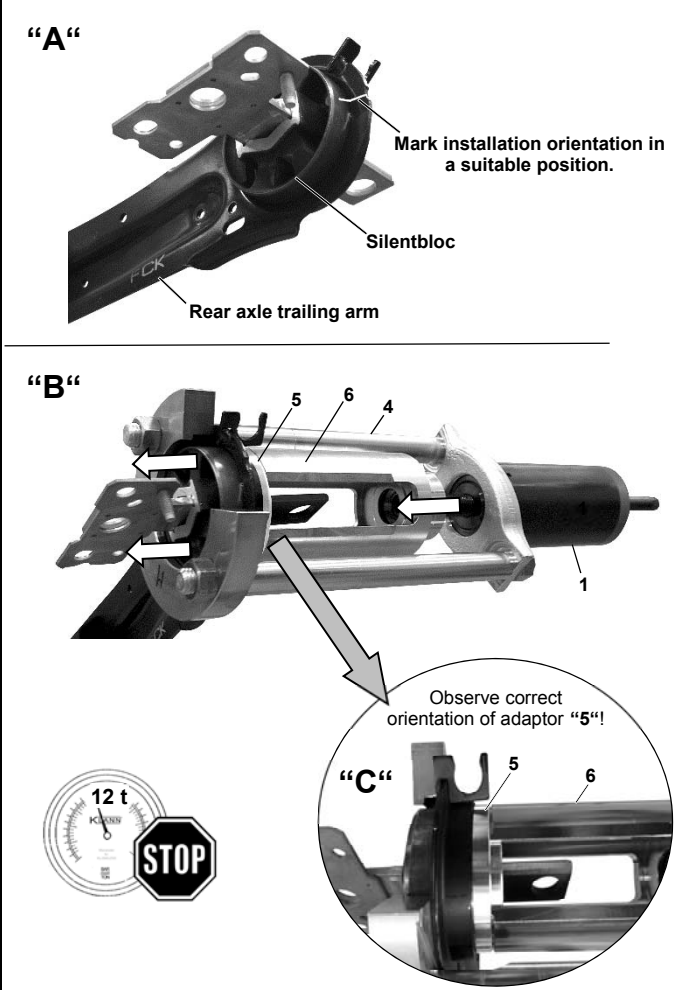
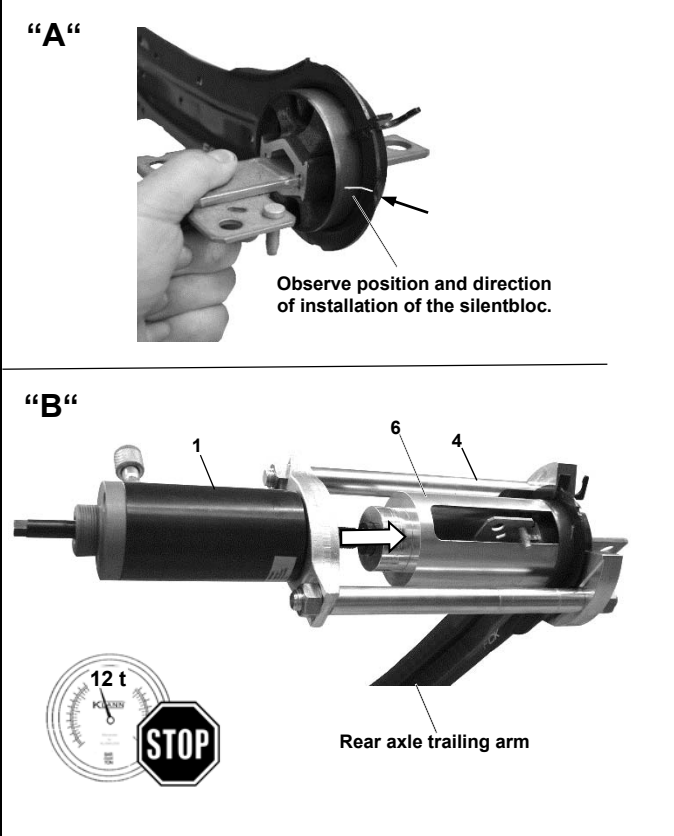

Fig. 4: Installing the silentbloc.



4. Silentbloc Removal / Silentbloc Installation

The following instructions describe the procedure of removing and installing a silentbloc on the rear axle trailing arm.

4.1 Removing the Silentbloc

1. **ATTENTION**

Failure to correctly align frame “4”, adaptor “5” and pressure sleeve “6” can result in damage to the rear axle trailing arm and tools.

- Be sure to align frame “4”, adaptor “5” and pressure sleeve “6” so as to enable the silentbloc to be removed without risk of collision.
- Observe correct orientation of adaptor “5”! (see Fig. 3 C)

⚠ Caution

The pressing device may fall off the axle.

- Always wear safety shoes/boots.
- Secure the pressing device to prevent it from falling, for example, by means of the **KL-0040-258 A** retaining device in conjunction with a transmission jack.

Before removing the silentbloc, mark its installation orientation in a suitable position and, where appropriate, copy it to the new silentbloc. (Fig. 3 A)

Mount the prepared/assembled pressing device to the rear axle as shown in Fig. 3 B.

2. Connect hydraulic cylinder “1” to hydraulic pump (accessory).

3. **⚠ DANGER**

When removing silentblobs, there is a risk that the press frame could break and fall to pieces. This will lead to parts becoming projectiles.

- Observe and do not exceed the maximum load capacity.
- Use hydraulic pump with pressure gauge **KL-0040-2529**.
- Use only GENUINE GEDORE Automotive spare parts.
- Always keep all parts of your body away from the axial extension of the tool.

Operate hydraulic hand pump and remove silentbloc. (Fig. 3 B)

During the removal process, read and observe the force indicated on the pressure gauge of the hydraulic pump.

4.2 Installing the Silentbloc

1. **ATTENTION**

Failure to correctly align pressure piece “6” and frame “4” can result in damage to the rear axle trailing arm and tools.

Failure to correctly align the silentbloc can damage the latter and the rear axle trailing arm. There is also a risk that the trailing arm cannot be refitted to the rear axle of the vehicle.

- Make sure pressure sleeve “6” and frame “4” are correctly seated.
- Observe the orientation mark previously set on the silentbloc or, where appropriate, the position and direction of installation of the silentbloc specified by the vehicle manufacturer. (Fig. 4 A)

Mount pressing device along with the new silentbloc to rear axle as shown in Fig. 4 B.

2. Connect hydraulic cylinder “1” to hydraulic pump (accessory).

3. Operate hydraulic pump and install silentbloc. (Fig. 3 B). During the installation process, read and observe the force indicated on the pressure gauge of the hydraulic pump. Stop the installation process as soon as the silentbloc is correctly positioned.

Fig. 5: Accessory: KL-0215-35 M25



Note: The hydraulic pressure and necessary force can be checked while operating the pump at pressure gauge KL-0040-2529 (supplied with the tool set). The pressure gauge features a tonne scale which is precisely adapted to our KL-0040-2500 hydraulic cylinder (17 t).

Fig. 6: Accessory: KL-0040-258 A



Fig. 7: Accessories to KL-0040-2800



Fig. 8: Spare parts: KL-0610-15 A

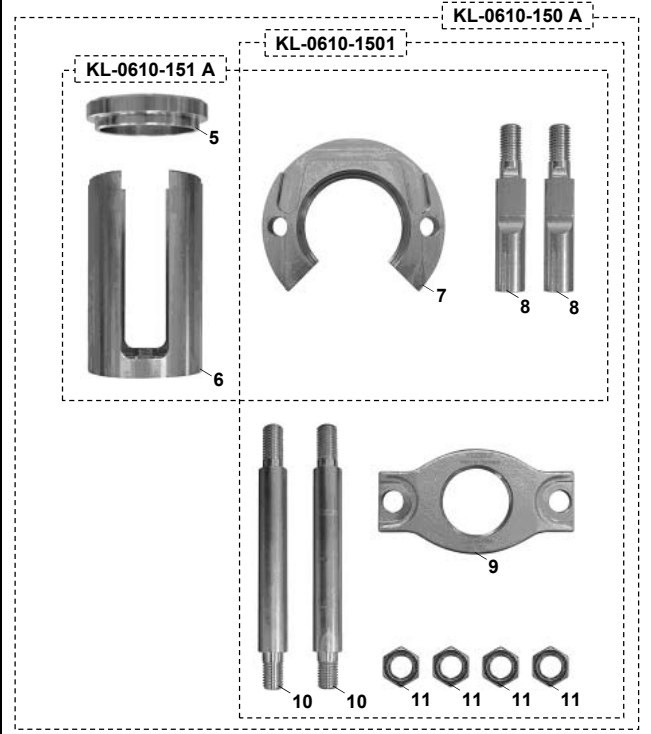

5. Care and Storage

ATTENTION Petroleum ether and chemical solvents can damage plastic parts. Always clean all parts after their use with a clean cloth only. In order to protect against corrosion, lightly lubricate all metal parts after their use and store them in a clean and dry place.

6. Accessories

KL-0215-35 M25 - Hydraulic Hand Pump

The KL-0215-35 M25 hydraulic hand pump is used to drive the hydraulic cylinder KL-0040-2500.

KL-0040-258 A - Retaining Device for Hydraulic Cylinder

The KL-0040-258 A retaining device is used in conjunction with a transmission jack (Plunger-Ø 30 mm) thus enabling for the easy and trouble-free operation of all those GEDORE Automotive tools that are driven by the hydraulic cylinder KL-0040-2500.

Accessories to KL-0040-2800 – Hydraulic Cylinder (28t)

These tools are necessary to allow the KL-0040-2800 hydraulic cylinder to be used as a drive for the KL-0610-150 A pressing device.

Part No.	Description	Qty
KL-0040-2810	Pressure Spindle	1
KL-0040-2855	Adaptor 2 1/4"-14 UNS to 2 3/4"-16 UN	1
KL-0039-1004	Retaining Adaptor with O-Ring for pressure spindle (Ø 18 mm)	1

7. Maintenance and Repair

by the GEDORE Automotive Service Centre

For safety reasons, as soon as damage is noticed on the pressing device, immediate steps must be taken to prevent it from being used. For professional inspection and repair of the tool, please contact the **GEDORE Automotive Service Centre**.

Address:

GEDORE Automotive GmbH

Breslauer Strasse 41 // 78166 Donaueschingen // Postfach 1329

78154 Donaueschingen - GERMANY

Tel.: +49 (0) 771 / 8 32 23-0 // Fax: +49 (0) 771 / 8 32 23-90

Email: info@gedore-automotive.com / Internet: www.gedore-automotive.com

For additional information concerning the use of our pressing device, please contact the **GEDORE Automotive Service Centre**.

8. Spare Parts List

KL-0610-15 A - Pressing Device with Hydr. Cyl., Rear Silentbloc, Ford/Volvo

Pos.	Part No.	Description	Qty
-	KL-0610-15 A	Pressing Device with Hydraulic Cylinder, Rear Silentbloc, Ford/Volvo	1

composed of:

Pos.	Part No.	Description	Qty
-	KL-0610-150 A	Pressing Device w/o Hydraulic Cylinder, Rear Silentbloc, Ford/Volvo	1
1	KL-0040-2500	Hydraulik Cylinder 17t	1
2	KL-0039-1002	Retaining Adaptor with O-Ring, for Clamping Nut M 20	1
3	KL-0039-1930	Pressure Spindle with O-Ring, M20 x 350 mm	1

Pos.	Part No.	Description	Qty
-	KL-0610-150 A	Pressing Device w/o Hydraulic Cylinder, Rear Silentbloc, Ford/Volvo	1

composed of:

Pos.	Part No.	Description	Qty
4	KL-0610-1501	Frame	1
5	KL-0610-1503 *	Adaptor	1
6	KL-0610-1502 *	Pressure Sleeve, Ford, Volvo	1

Pos.	Part No.	Description	Qty
4	KL-0610-1501	Frame	1

composed of:

Pos.	Part No.	Description	Qty
7	KL-0610-1501-1 *	Support Ring	1
8	KL-0610-1501-2 *	Pull Rod Extension	2
9	KL-0039-1144	Base Plate, 2 1/4"-14 UNS	1
10	KL-0215-4004	Pull Rod	2
11	KL-0049-3004	Hex Nut M18	4

KL-0610-151 A - Upgrade Kit, Ford/Volvo (hydraulic kit)

Composed of the articles marked with an *. (see tablee KL-0610-15 A)

9. Environmentally Safe Disposal

Recycle/dispose of the pressing device and its packaging material in compliance with the legal rules and regulations in force.